

SKR-HT

SCREW-IN ANCHORS

- Suitable for uncracked concrete
- Hexagonal head of increased size
- Thread is suitable for dry fastening
- Electrogalvanized carbon steel
- Through fastening
- No fastener expansion



ENVIRONMENT	SC2	C2	T2
MATERIAL	Zn ELECTRO PLATED		

SKR-HT

hexagonal head

d ₁ [mm] [in]	CODE	L [mm] [in]	t _{fix} [mm] [in]	h _{1,min} [mm] [in]	h _{nom} [mm] [in]	d ₀ [mm] [in]	d _{F timber} [mm] [in]	d _{F steel} [mm] [in]	SW [mm] [in]	T _{inst} [Nm] [ft lbf]	pcs
7.5 0.30	SKR7560H	60 2 3/8	10 3/8	60 2 3/8	50 1 15/16	6 0.237	8 0.315	8-10 0.315 0.394	13 1/2"	15 11	50
	SKR7580H	80 3 1/8	30 1 3/16	60 2 3/8	50 1 15/16	6 0.237	8 0.315	8-10 0.315 0.394	13 1/2"	15 11	50
	SKR75100H	100 4	20 1 3/16	90 3 1/2	80 3 1/8	6 0.237	8 0.315	8-10 0.315 0.394	13 1/2"	15 11	50
10 0.40	SKR1080H	80 3 1/8	30 1 3/16	65 2 9/16	50 1 15/16	8 0.315	10 0.394	10-12 0.394 0.473	16 5/8"	25 18	50
	SKR10100H	100 4	20 1 3/16	95 3 3/4	80 3 1/8	8 0.315	10 0.394	10-12 0.394 0.473	16 5/8"	25 18	25
	SKR10120H	120 4 3/4	40 1 9/16	95 3 3/4	80 3 1/8	8 0.315	10 0.394	10-12 0.394 0.473	16 5/8"	25 18	25
	SKR10140H	140 5 1/2	60 2 3/8	95 3 3/4	80 3 1/8	8 0.315	10 0.394	10-12 0.394 0.473	16 5/8"	25 18	25
	SKR10160H	160 6 1/4	80 3 1/8	95 3 3/4	80 3 1/8	8 0.315	10 0.394	10-12 0.394 0.473	16 5/8"	25 18	25
12 0.48	SKR12100H	100 4	20 1 3/16	100 4	80 3 1/8	10 0.394	12 0.473	12-14 0.473 0.552	18 23/32"	50 37	25
	SKR12120H	120 4 3/4	40 1 9/16	100 4	80 3 1/8	10 0.394	12 0.473	12-14 0.473 0.552	18 23/32"	50 37	25
	SKR12140H	140 5 1/2	60 2 3/8	100 4	80 3 1/8	10 0.394	12 0.473	12-14 0.473 0.552	18 23/32"	50 37	25
	SKR12160H	160 6 1/4	80 3 1/8	100 4	80 3 1/8	10 0.394	12 0.473	12-14 0.473 0.552	18 23/32"	50 37	25
	SKR12200H	200 8	120 4 3/4	100 4	80 3 1/8	10 0.394	12 0.473	12-14 0.473 0.552	18 23/32"	50 37	25
	SKR12240H	240 9 1/2	160 6 1/4	100 4	80 3 1/8	10 0.394	12 0.473	12-14 0.473 0.552	18 23/32"	50 37	25
	SKR12280H	280 11	200 8	100 4	80 3 1/8	10 0.394	12 0.473	12-14 0.473 0.552	18 23/32"	50 37	25
SKR12320H	320 12 5/8	240 9 1/2	100 4	80 3 1/8	10 0.394	12 0.473	12-14 0.473 0.552	18 23/32"	50 37	25	

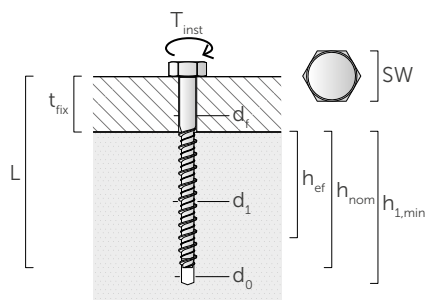

d₁ external diameter of anchor
 L anchor length
 t_{fix} maximum fastening thickness
 h_{1,min} minimum hole depth
 h_{nom} nominal anchoring depth
 h_{ef} effective anchoring depth
 d₀ hole diameter in the concrete support
 d_F maximum hole diameter in the element to be fastened
 SW wrench size
 T_{inst} tightening torque

RELATED PRODUCTS



PONY
POCKET AIR PUMP FOR HOLE CLEANSING



HTW
ANGLE BRACKET FOR SHEAR LOADS



HT100
ANGLE BRACKET 100 FOR SHEAR LOADS

ASSEMBLY

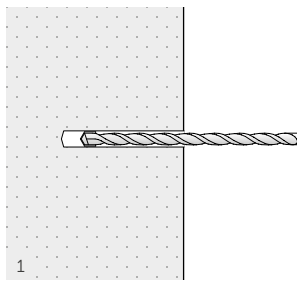

1 Drill a hole in rotary percussion mode

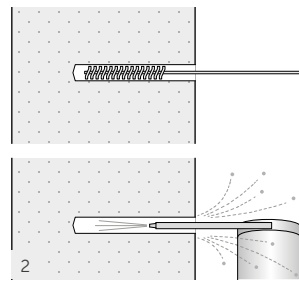

2 Clean the hole

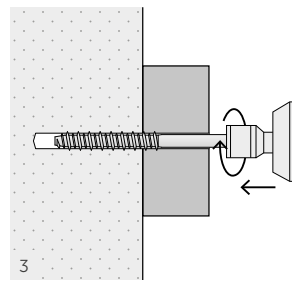

3 Position the object to be fixed and install the screw with a pulse screw gun

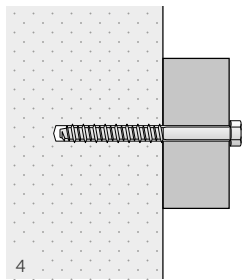

4 Ensure the anchor head is in complete contact with the object to be fixed

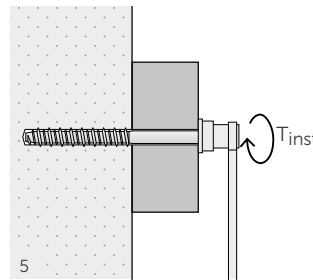

5 Check the tightening torque T_{inst}

INSTALLATION

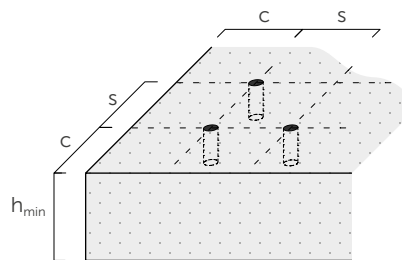

Spacing and distances for tensile loads			SKR-HT		
			Ø7,5	Ø10	Ø12
Minimum spacing	$s_{min,N}$	[mm]	50	60	65
Minimum edge distance	$c_{min,N}$	[mm]	50	60	65
Minimum thickness of concrete support	h_{min}	[mm]	100	110	130
Critical spacing	$s_{cr,N}$	[mm]	100	150	180
Critical edge distance	$c_{cr,N}$	[mm]	50	70	80
Spacing and distances for shear loads			Ø7,5	Ø10	Ø12
Minimum spacing	$s_{min,V}$	[mm]	50	60	70
Minimum edge distance	$c_{min,V}$	[mm]	50	60	70
Minimum thickness of concrete support	h_{min}	[mm]	100	110	130
Critical spacing	$s_{cr,V}$	[mm]	140	200	240
Critical edge distance	$c_{cr,V}$	[mm]	70	110	130

For spacing and distances smaller than the critical ones, strength values have to be reduced depending on the installation parameters.

STRUCTURAL VALUES

Valid for a single anchor in thickened C20/25 grade concrete with a thin reinforcing layer when spacing and edge-distance are not limiting parameters.

ADMISSIBLE VALUES

		UNCRAKED CONCRETE		
		<i>tension</i>	<i>shear⁽¹⁾</i>	<i>head pull-through</i>
		$N_{1,rec}$	V_{rec}	$N_{2,rec}$
		[kN]	[kN]	[kN]
SKR-HT	7,5	2,13	2,50	1,19 ⁽²⁾
	10	6,64	6,65	1,86 ⁽²⁾
	12	8,40	8,18	2,83 ⁽²⁾

NOTES

- ⁽¹⁾ When evaluating the anchor global-strength, the shear strength on the element to be fastened (e.g. timber, concrete, ...) must be considered separately based on the material adopted.
- ⁽²⁾ All values refer to SKR installed with DIN 9021 (ISO 9073) washer.

GENERAL PRINCIPLES

- Recommended admissible shear and tensile values are compliant with Certificate Nr. 2006/5205/1 released from Politecnico di Milano and obtained by considering a safety factor of 4 for the failure load.